



Village of New Maryland

584 New Maryland Hwy., New Maryland, NB E3C 1K1
T. 506.451.8508 F. 506.450.1605 www.vonm.ca

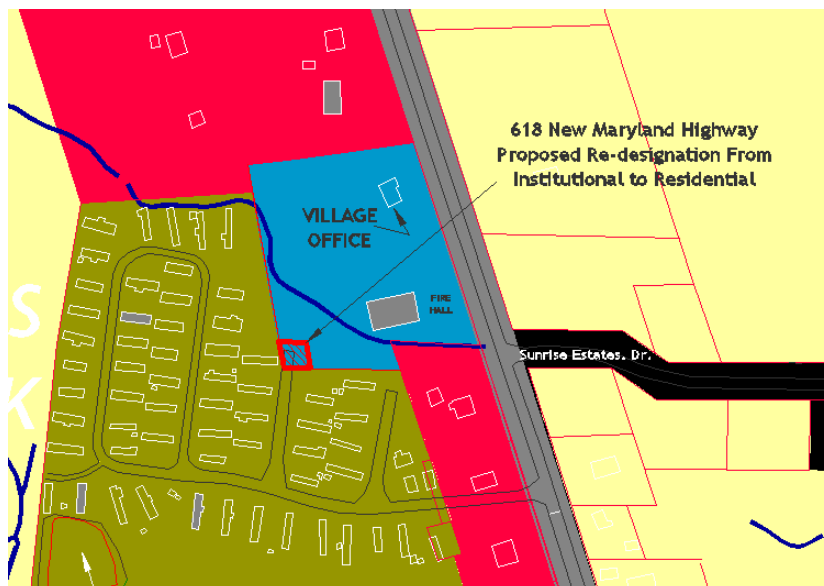
Proposed Municipal Plan By-Law Future Land Use Map Amendment 03-01-2019 and Zoning By-Law Map Amendment 04-01-2019

Background Information

Proposed Future Land Use Map Amendment 03-01-2019 and Zoning Map Amendment 04-01-2019 in favor of Peterson's Mini-Home Park involves the re-designation of a small parcel of land from an Institutional to a Residential land use. The purpose is to permit a minor adjustment to the present zone boundary to align with a past revision to the property boundary. The corresponding amendment to the Zoning Map is also proposed to complete conversion of PID 75347989 to a Residential Mini-Home Park (RMHP) zone.

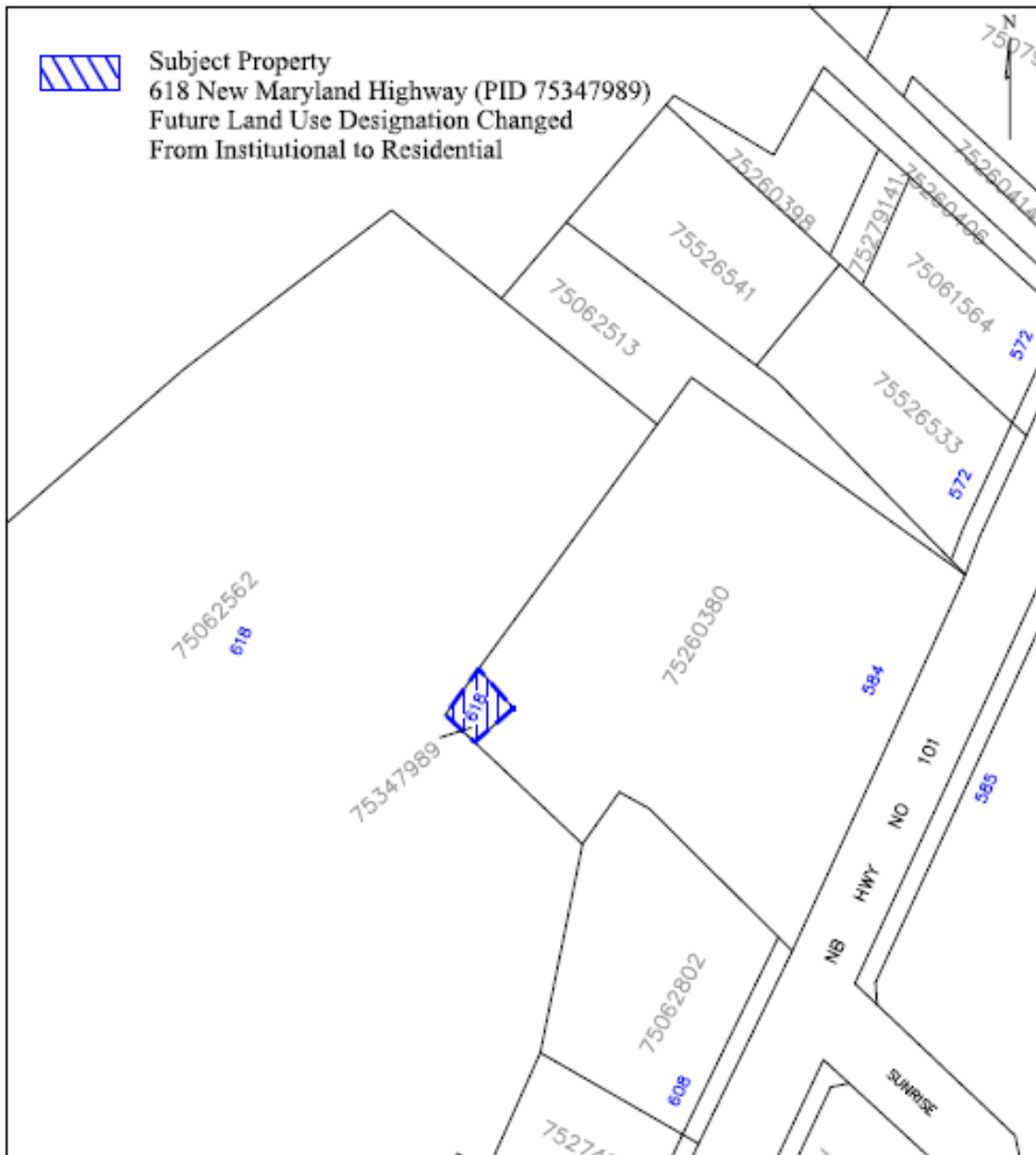


Figure 1 - Peterson's Mini-Home Park – 618 New Maryland Highway - (PID 75347989)



**Figure 2
Peterson's Mini-Home Park – 618 New Maryland Highway - (PID 75347989)
Proposed Future Land Use Map Amendment From Institutional to Residential
To Align Zone Boundary with a Past Revision to the Property Line**

Village of New Maryland
Municipal Plan By-Law Amendment No. 03-01-2019
Schedule "A" - DRAFT

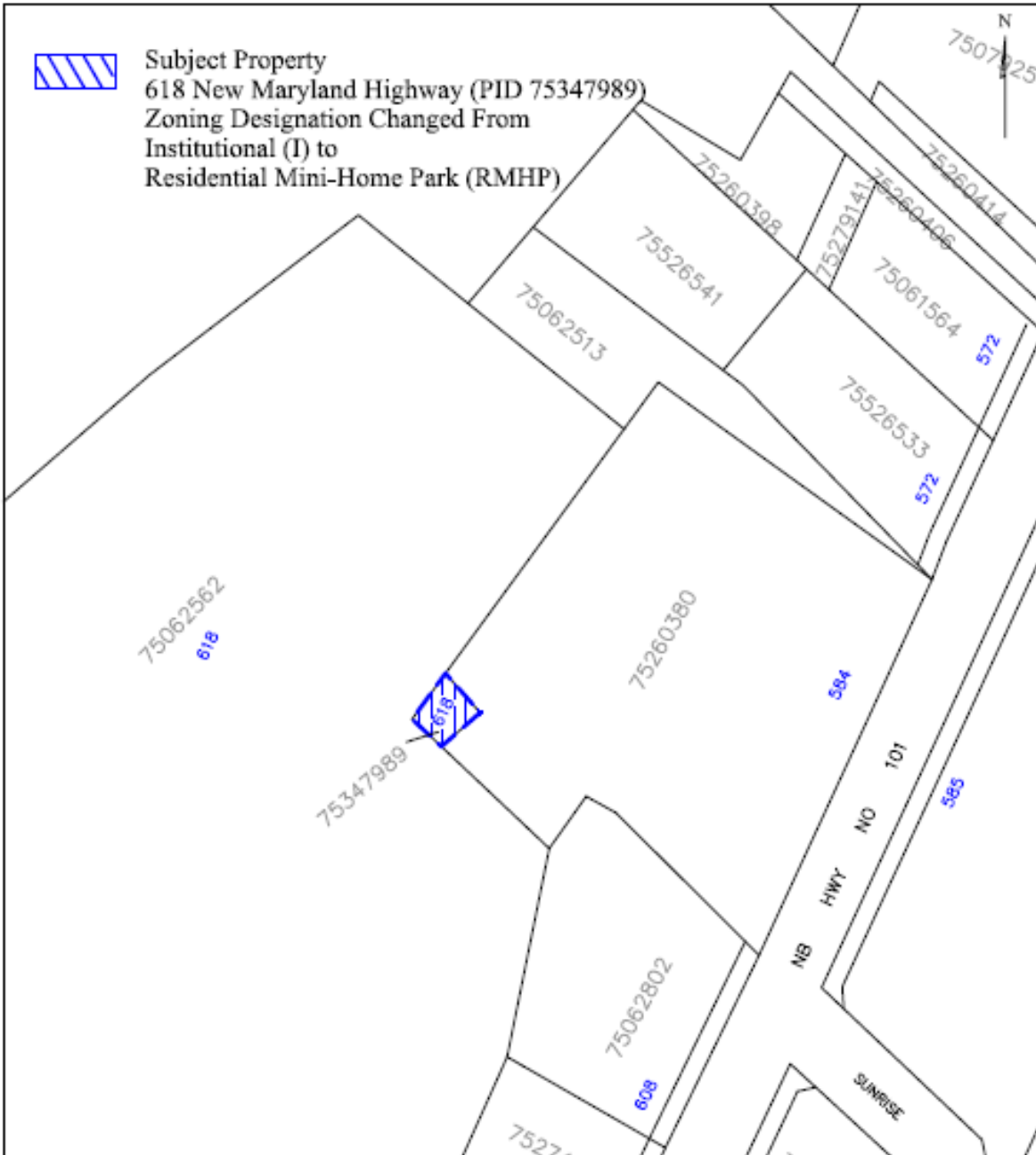


N.T.S.

Judy Wilson-Shee
Mayor

Cynthia Geldart
CAO/Clerk

Village of New Maryland
Zoning By-Law Amendment No. 04-01-2019
Schedule "A" - DRAFT



N.T.S.

Judy Wilson-Shee
Mayor

Cynthia Geldart
CAO/Clerk